

# BALEAR 210

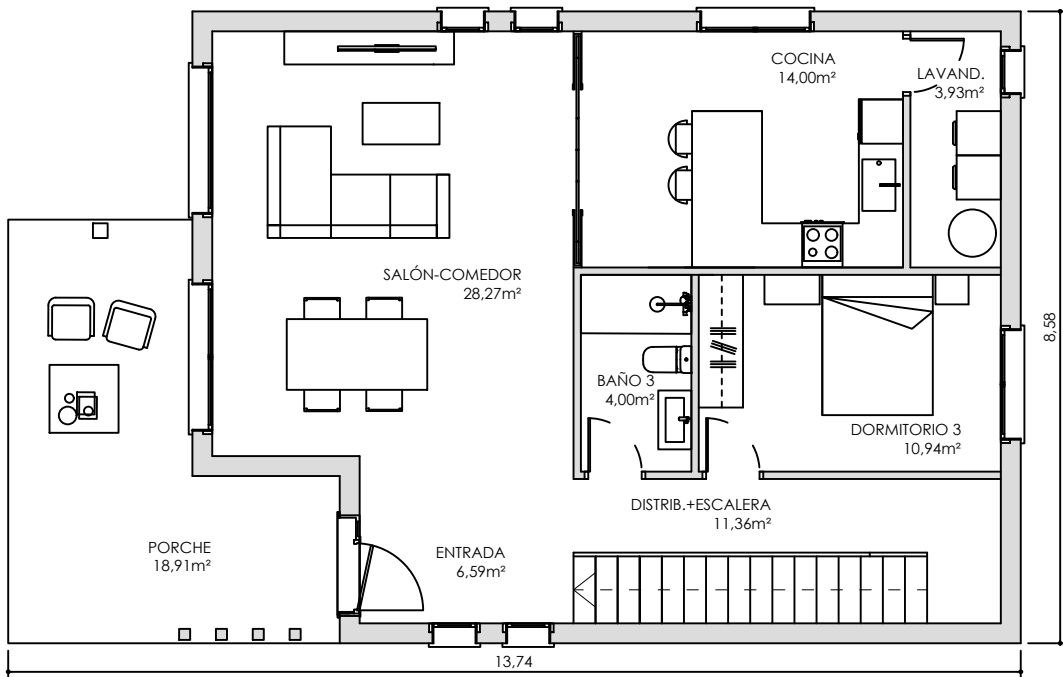

SUPERFICIE CONSTRUIDA	
PLANTA BAJA	91,88 m <sup>2</sup>
PORCHE	18,91 m <sup>2</sup>
<b>TOTAL SUPERFICIE CONSTRUIDA PB</b>	<b>110,80m<sup>2</sup></b>
<b>TOTAL SUPERFICIE CONSTRUIDA P1</b>	<b>99,21m<sup>2</sup></b>
<b>TOTAL SUPERFICIE CONSTRUIDA PB+P1</b>	<b>210,00m<sup>2</sup></b>

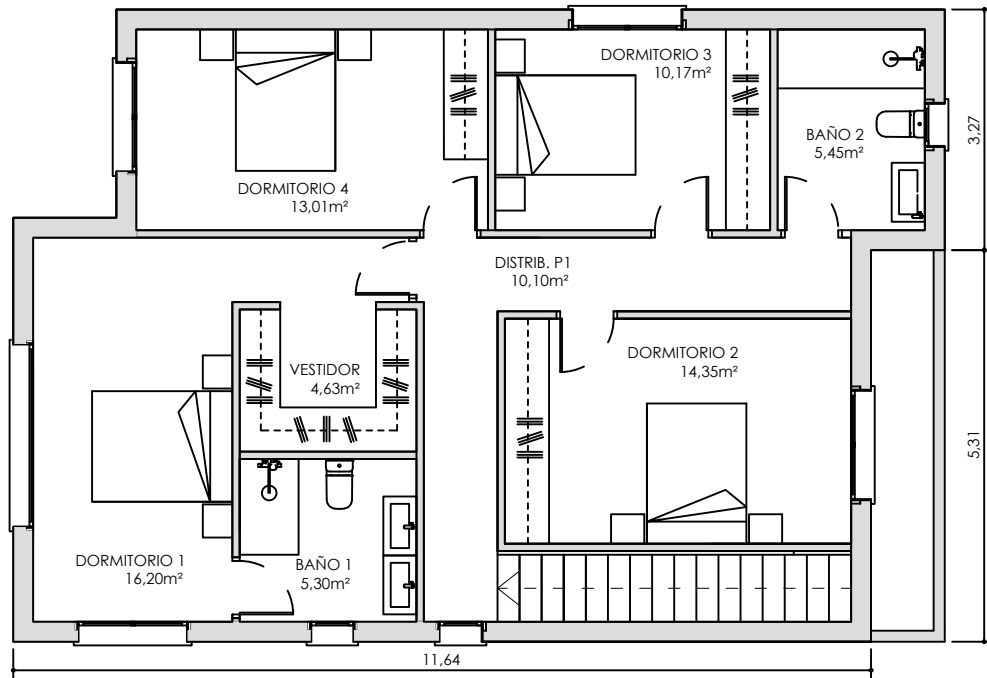