

# ALALBA BALEAR

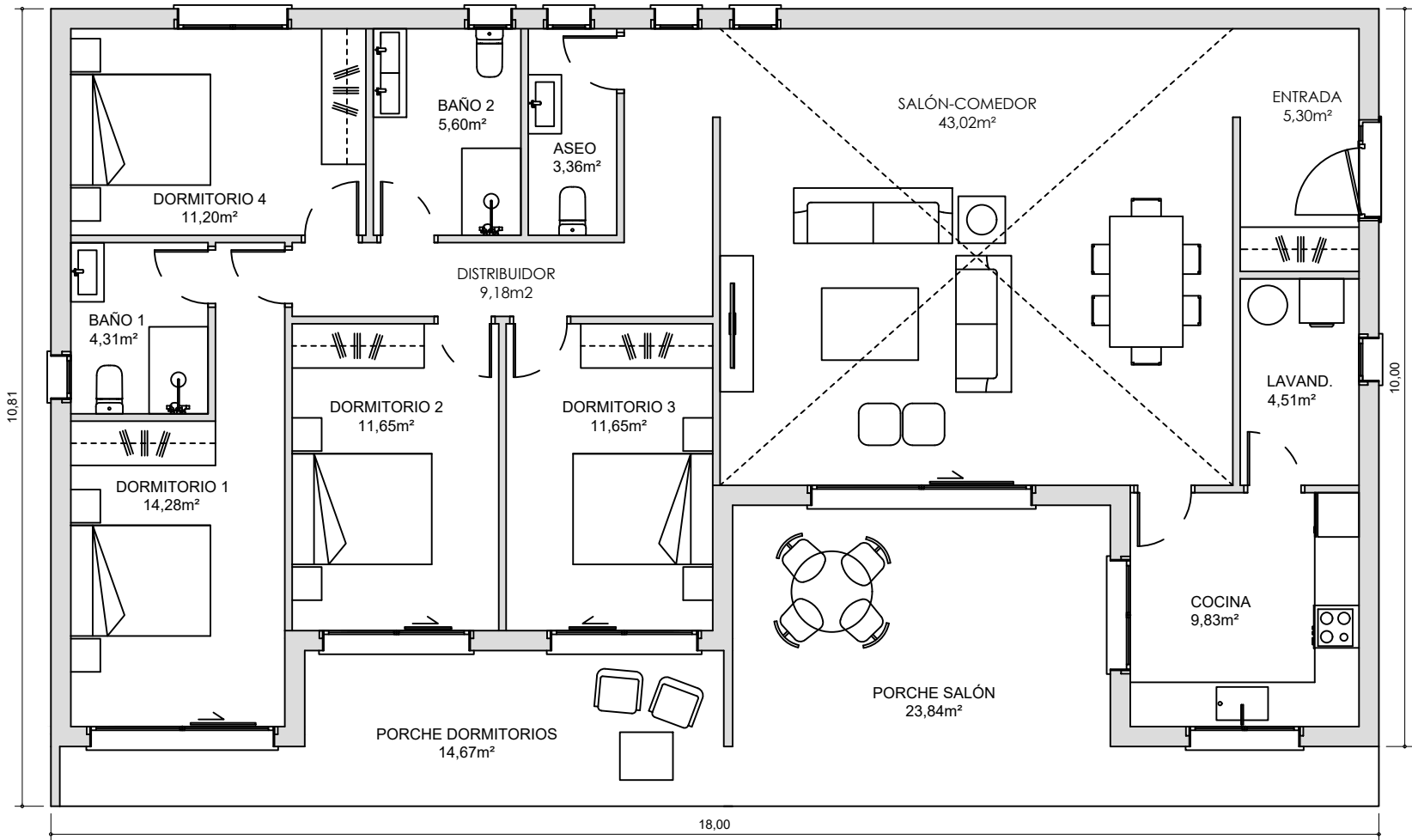

SUPERFICIE CONSTRUIDA	
PLANTA BAJA	155,72 m <sup>2</sup>
PORCHES	38,51 m <sup>2</sup>

<b>TOTAL SUPERFICIE CONSTRUIDA</b>	<b>194,23m<sup>2</sup></b>
------------------------------------	----------------------------

